

72" I.D. MANHOLE - 12" EXTENDED BASE

WITH FLATTOP

NOT TO SCALE: ALL DIMENSIONS ARE SUBJECT TO ALLOWABLE SPECIFICATION TOLERANCES

MATERIALS & FEATURES

CONCRETE: 4,000 PSI, 28 DAY STRENGTH.
REINFORCING: 3"x8" W3 x W25 WELDED WIRE IN ALL SURFACES & BOTTOM

BOTTOM

#4 BAR @90° CROSS IN BOTTOM & SIDES

#4 BAR @ 12" ON CENTER EACH WAY IN BOTTOM (CONTINUOUS AROUND OPENINGS & SIDES)

AVERAGE WEIGHT OF 72" DEPTH BASE = 15,000 LBS

ESTIMATED WEIGHT OF RISER & FLAT

TOP SECTIONS = 1,500 LBS / VERTICAL FOOT

EXCEEDS ASTM C-478-03A

HOLES AS SPECIFIED - MAX. 32" Ø

FLAT TOP/ TRANSITION LOAD RATING = H20

RISER SECTIONS: 12", 18", 24", 32", 36", 48", 60" AND 72"
BASE SECTIONS AS SPECIFIED

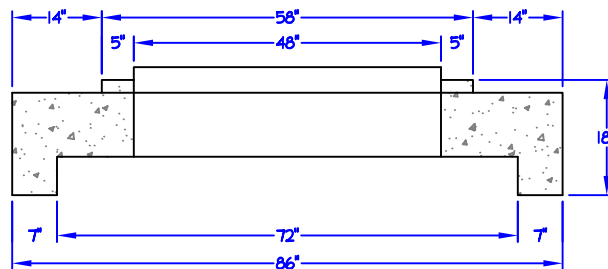
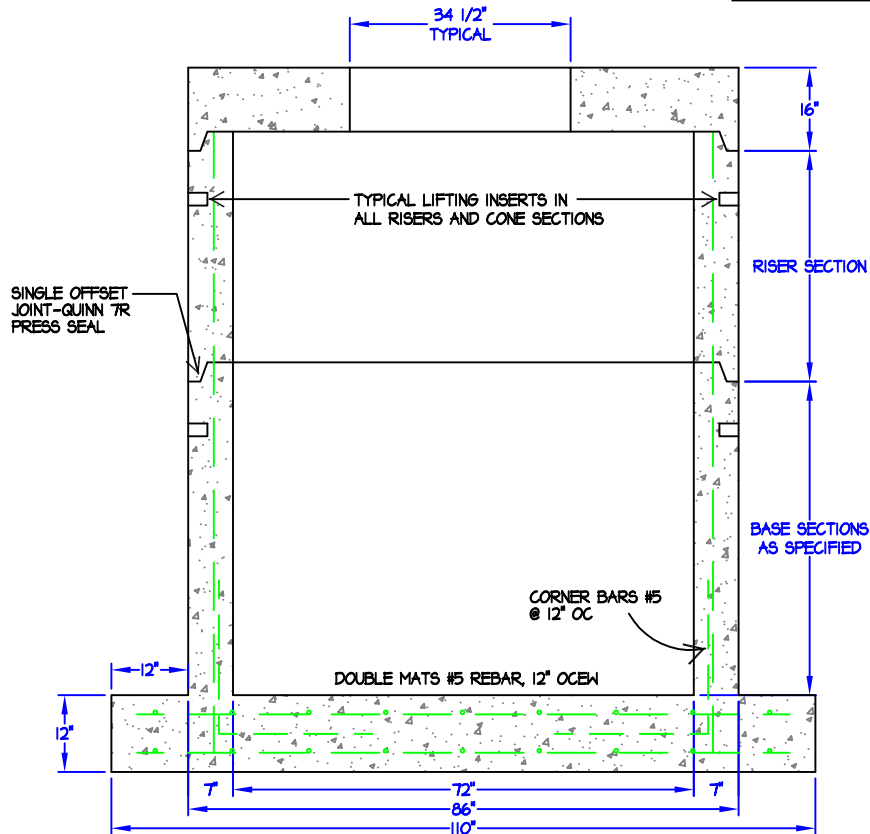

TRANSITION PIECE

72" TO 48"

MAXIMUM MANHOLE DEPTH 40 FEET BELOW SURFACE GRADE



Capital Concrete Products

5264 Hwy. 71 East • Del Valle, Texas 78617

TITLE:	72" I.D. MANHOLE EXTENDED 12" BASE - NO CH.
FILE LOC.:	MANHOLES/ 72 ID MANHOLES
DRAWN BY:	SUSAN MENTA
DATE:	OCTOBER 09, 2009