

32" CONE DETAILS

NOT TO SCALE: ALL DIMENSIONS ARE
SUBJECT TO ALLOWABLE SPECIFICATION
TOLERANCES

MATERIALS & FEATURES

CONCRETE: 4,000 PSI, 28 DAY STRENGTH.
EXCEEDS ASTM C-478-03A

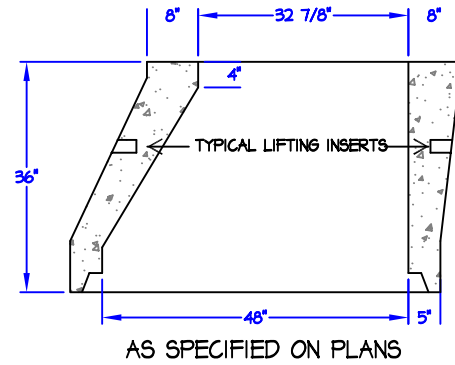
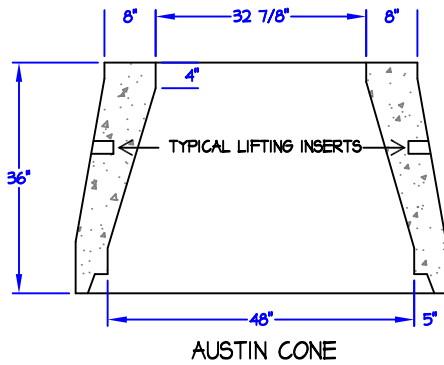
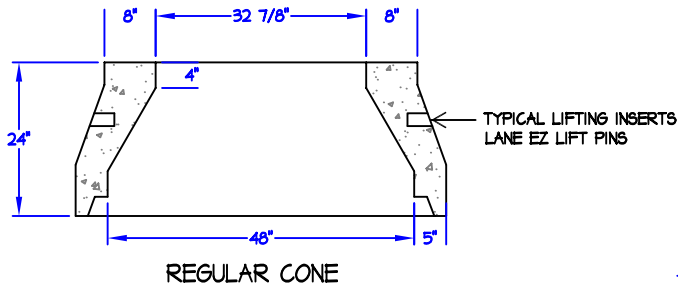

Capital Concrete Products

5264 Hwy. 71 East • Del Valle, Texas 78617

TITLE:	32" CONE DETAILS
FILE LOC.:	MANHOLES/ OTHER MANHOLES
DRAWN BY:	SUSAN MENTA
DATE:	OCTOBER 14, 2009